

# UNIT PLAN

## FLAT D1 | 3B 2T

Available in Tower B

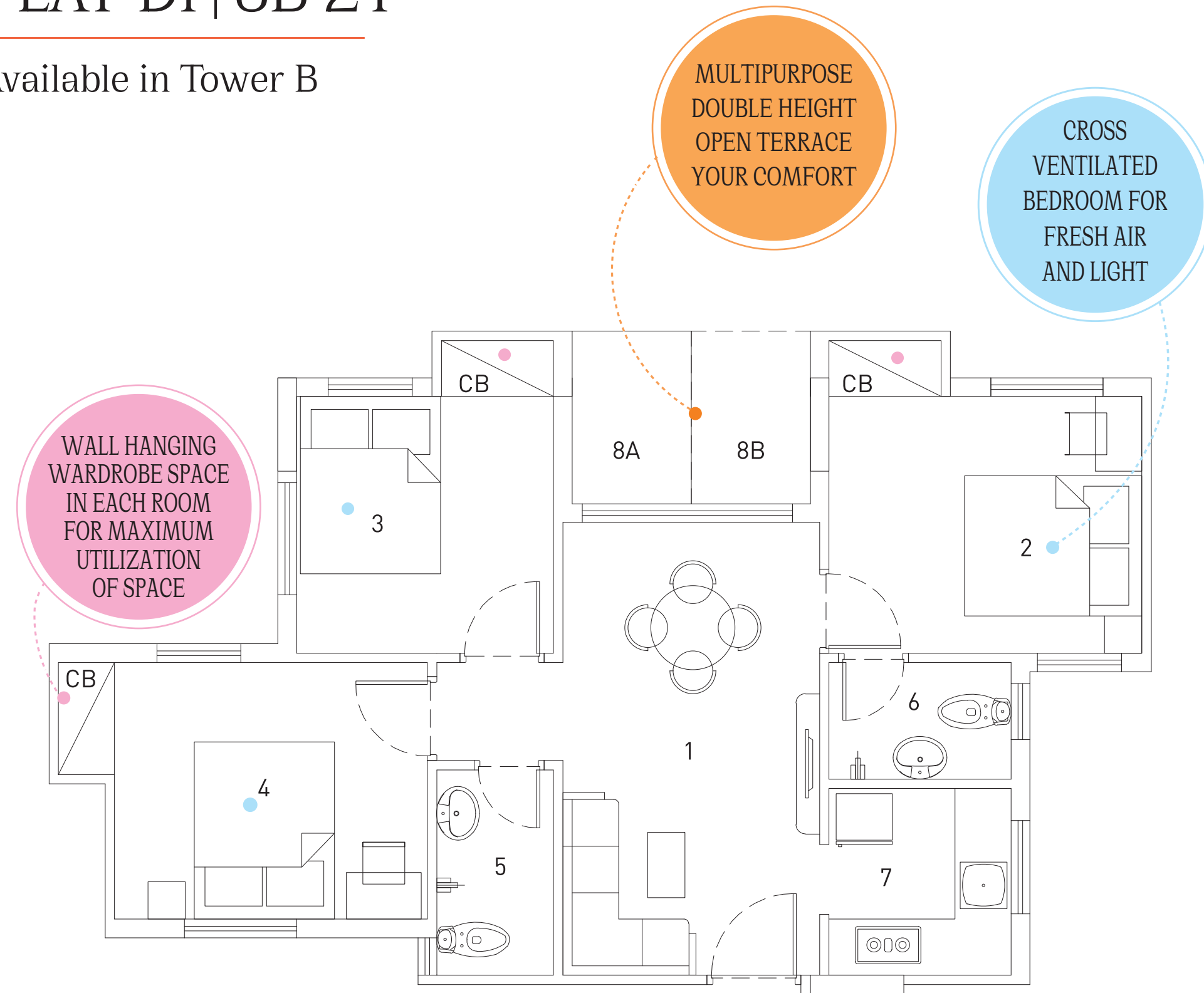

Carpet area	Built up area	Standard built up area
586	678	945

① Living/Dining	9'0" x 15'11"
② Bedroom	11'0" x 11'0" (11'0" x 9'0" without CB)
③ Bedroom	9'0" x 11'0" (9'0" x 9'0" without CB)
④ Bedroom	13'0" x 11'0" (11'0" x 9'0" without CB)
⑤ Toilet	4'1" x 7'3"

⑥ Toilet	6'5" x 4'1"
⑦ Kitchen	6'5" x 6'7"
⑧A Balcony	4'2" x 6'1"
⑧B Balcony	4'2" x 6'1"